

Condition 2 Large Trading Store 2 Number Conventional Units of 350kg Each

Condition 4 Small Trading Store 1 Number Conventional Unit of 350kg

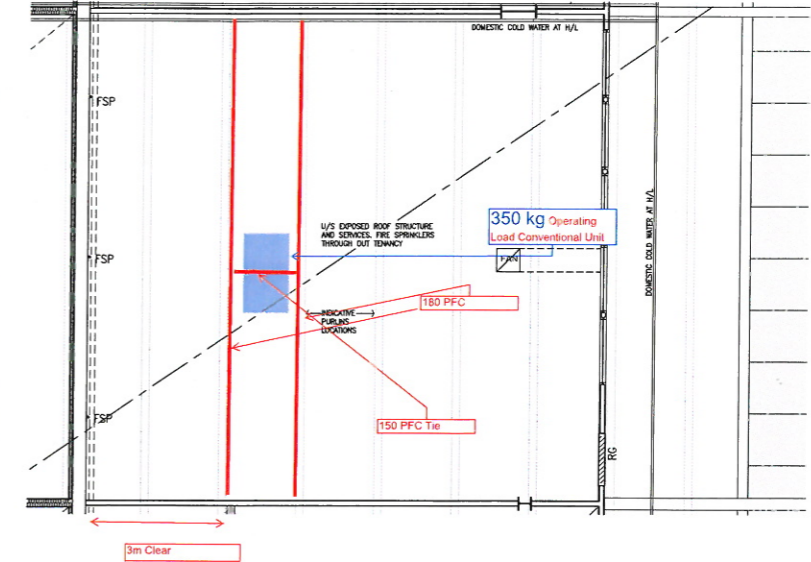
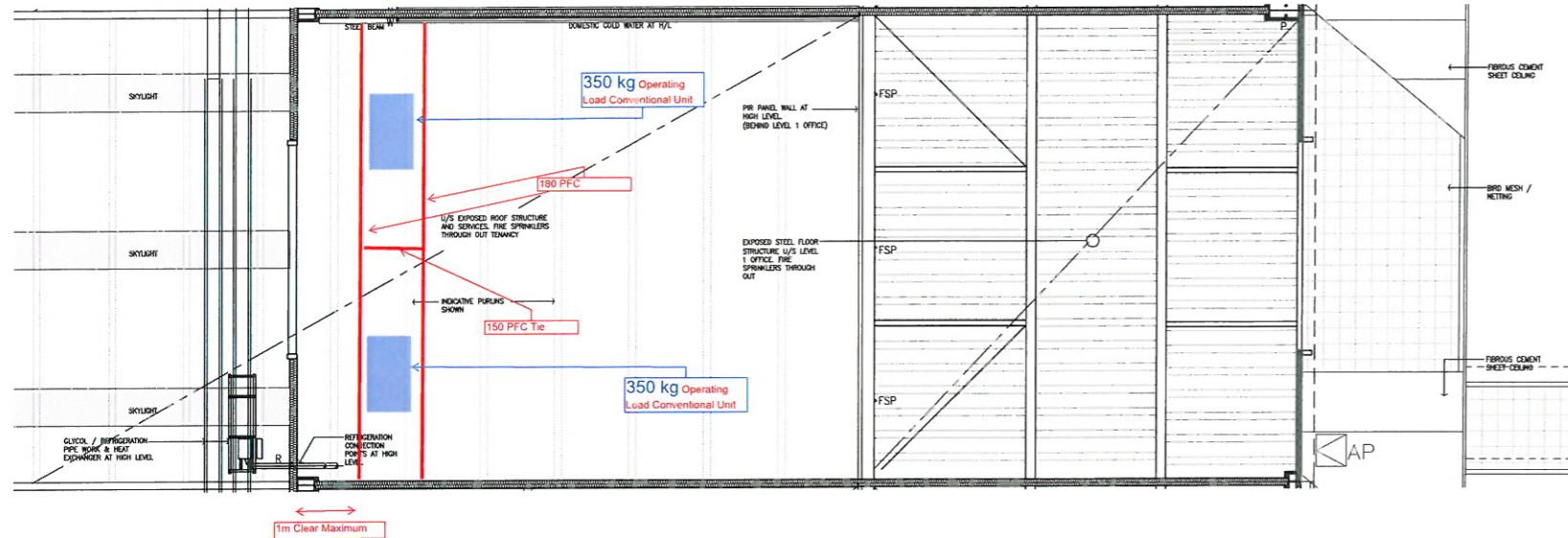
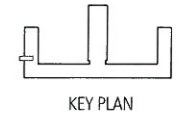

- TENANCY WALL TYPES
- TW1 100mm THICK INSULATED PANEL - FROM GROUND FLOOR LEVEL TO UNDERSIDE OF ROOF STRUCTURE
 - TW2 100mm THICK INSULATED PANEL FROM FLOOR LEVEL TO UNDERSIDE OF 1ST FLOOR STRUCTURE OVER WITH 300mm HIGH (MINIMUM) 30-25 CONCRETE GARD PROTECTION SHEETLY IN FRONT OF PANEL, FACING THE BUYER'S WALK
 - TW3 1200mm HIGH FINISHLINE PRECAST CONCRETE GARD WITH 100mm THICK INSULATED PANEL ABOVE
 - TW4 STRUCTURAL STEEL TRUSS WITH METAL STUD WALL (BY TOWARD) FACING THE OFFICE AREA AND 75mm THICK INSULATED PANEL FACING THE PRODUCT STORAGE AREA VOID SPACE
 - TW5 METAL STUD WALL WITH PLASTERBOARD LINING TYPICALLY TO ONE SIDE ONLY. LE. A MINIMUM OF ONE PARTY WALL LEAD TO EACH REMOVING OFFICE TENANCY AND ONE WALL WITH EXPOSED STEGUS WITH LINING BEHIND
 - TW6 2700mm HIGH CLEAR GLAZED ALUMINIUM GLAZING SUITE 1 AND 2700mm HIGH CLEAR GLAZED ALUMINIUM GLAZING SUITE 2. METAL STUD WALL ABOVE ALUMINIUM GLAZING SUITE WITH PLASTERBOARD LINING TO INSULATED SIDE OF STUDS ONLY
 - TW7 METAL STUD WALL WITH FINISH COATED SHEET LINING TO INSULATED SIDE OF STUDS & PLASTERBOARD LINING TO OFFICE SIDE
 - TW8 INSULATED PANEL, CLADDING AND/OR STRUCTURAL COLLAR (FROM FLOOR LEVEL)
 - TW9 75mm THICK INSULATED PANEL (SEAL OF LEVEL 1 SMALL TRADING STORE OFFICE) FACING THE PRODUCT STORAGE AREA VOID SPACE. FUTURE STUD WALL BY TOWARD
 - TW10 INSULATED PANEL (DOUBLE SLUNG DOOR)
 - TW11 METAL STUD WALL WITH PLASTERBOARD LINING TO BOTH SIDES

- SERVICES LEGEND
- FW BUCKET TRAP AT FLOOR, LOCATED ON LOW SIDE OF CHASED FLOOR AND BACK TO BACK WITHIN WALL. LOCAL FALL IN SURFACE OF SLAB
 - TRW TREATED RAINWATER TAP, EACH PIPE TO BE LOCATED ABOVE PRECAST CONCRETE GARD AND AT EVERY OTHER PARTY WALL. ONE PIPE IS TO FEED TWO TOWARDS
 - S WASTE CONNECTION POINT CARVED FLUSH WITH FLOOR SLAB
 - P BUCKET TRAP WATER / PRIMER PIPE FIXED TO WALL FROM HIGH LEVEL AND CONNECTIONS INTO SLAB WITH PRIMER DEVICE AT HIGH LEVEL
 - TW TRICE WASTE CONNECTION POINT AT FLOOR
 - R RETROFECTION CONNECTION POINTS AT HIGH LEVEL
 - W COLD WATER CONNECTION POINT AT HIGH LEVEL, UNLESS NOTED OTHERWISE
 - HW HOT WATER CONNECTION POINTS AT HIGH LEVEL
 - G GAS CONNECTION POINT
 - DB ELECTRICAL SWITCHBOARD
 - IS ROLLER SHUTTER RELAY SWITCH (AT HIGH LEVEL, HEAVY MOTOR)
 - CS ROLLER SHUTTER CONTROL SWITCH
 - K KEY OPERATION POINT FOR ELECTRIC ROLLER SHUTTER
 - EX EXHAUST FAN AT HIGH LEVEL
 - CO FAN ON-OFF CONTROL SWITCH
 - RG RELAY AN GRILLE (HIGH LEVEL) OVER DOOR
 - FSP FIRE SERVICES PREWORK
 - FHR FIRE HOSE REEL
 - EE LEVEL 1 OFFICE CEILING FAN (HIGH LEVEL)
 - INDICATING SERVICES (CONTRACTOR TO BE TYPE, DOUBLE UP FLOOR FLOOR WITH COMPACTED ZONE
 - PT REINFORCING STRINGS, LAYERS & INDICATING ONLY AND THAT SLAB IS TO BE SCANNED PRIOR TO ANY FORMS DEEPER THAN 50mm
- DOOR LEGEND
- D1 2000 x 800 x 30mm THICK SOLID CORE DOOR
- NOTE: PRESEE LOCATION OF INDIVIDUAL SERVICES & SERVICE CONNECTION POINTS BEFORE AND INDICATING ONLY & MAY BE SUBJECT TO ADJUSTMENT AS FOR FUNCTIONAL & CONSTRUCTION REQUIREMENTS

01 LARGE TRADING STORE RCP- N002 1:50

02 LARGE TRADING STORE LEVEL 1 OFFICE RCP- N102 1:50

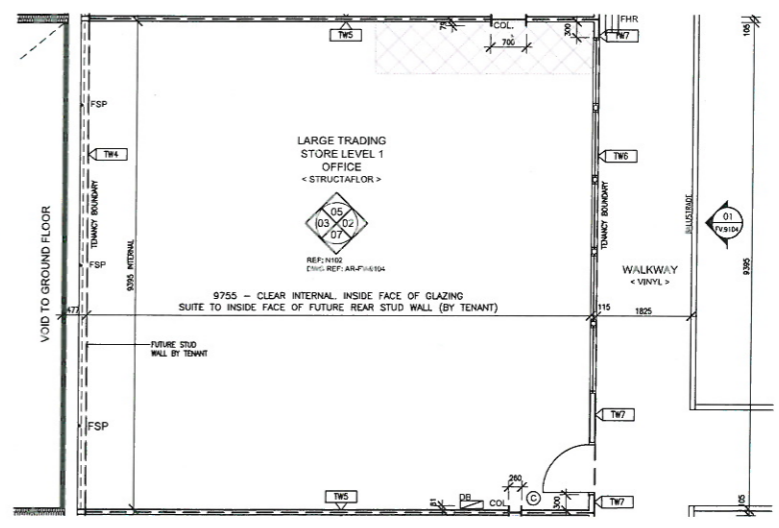
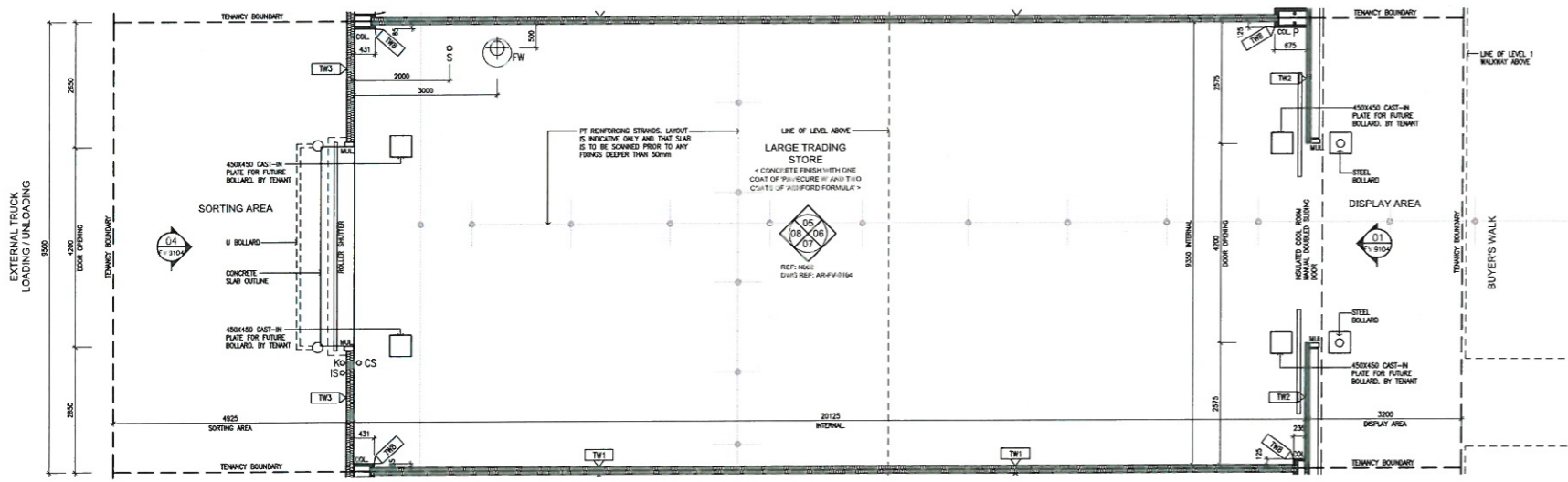

03 LARGE TRADING STORE PLAN- N002 1:50

04 LARGE TRADING STORE LEVEL 1 OFFICE PLAN- N102 1:50

DATE	REVISION	BY	CHK	APP	DATE	SCALE	APP	DATE
01	ISSUED FOR RENEW	TC	MA	DEB	11			



Architect: Urban Design Interiors

MELBOURNE MARKET RELOCATION PROJECT EPPING

MAJOR PROJECTS VICTORIA

FRUIT & VEGETABLE MARKET TENANCY LEASING PLAN N002,N102

CLIENT NO.	AR-FV-9103	PROJECT NO.	D1
SCALE	1:50	DATE	08/15
DESIGNED BY	TC	CHECKED BY	MA
DATE	08/15	DATE	08/15

PRELIMINARY

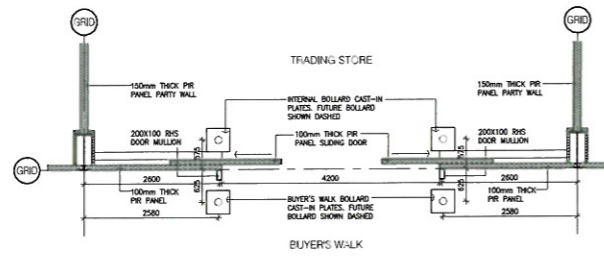

1 TYPICAL PLAN OF 4.2M OPENING FROM BUYER'S WALK
1:50

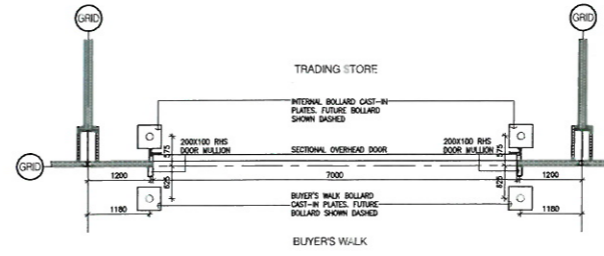

2 TYPICAL PLAN OF 7M OPENING FROM BUYER'S WALK
1:50

NOTE:
SERVICES PENETRATIONS ARE YET
TO BE CO-ORDINATED

REFER TO FINISHES SCHEDULE
FOR PIR PANEL COLOURS:

IC01
IC02
IC03
IC05

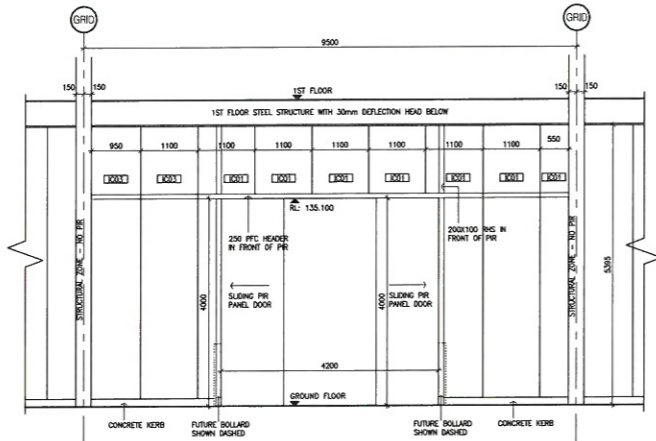

3 TYPICAL ELEVATION OF 4.2M OPENING FROM BUYER'S WALK
1:50

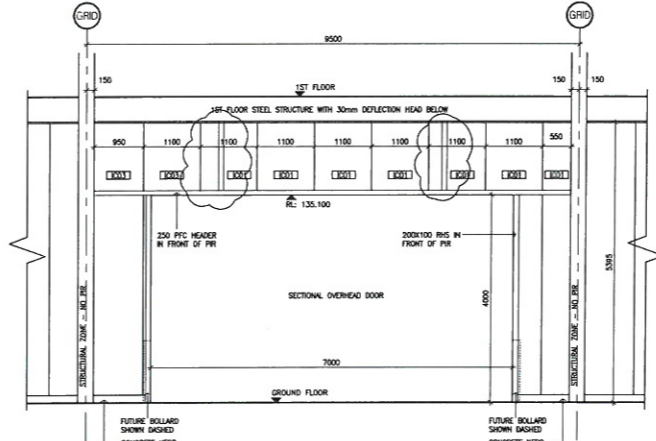

4 TYPICAL ELEVATION OF 7M OPENING FROM BUYER'S WALK
1:50

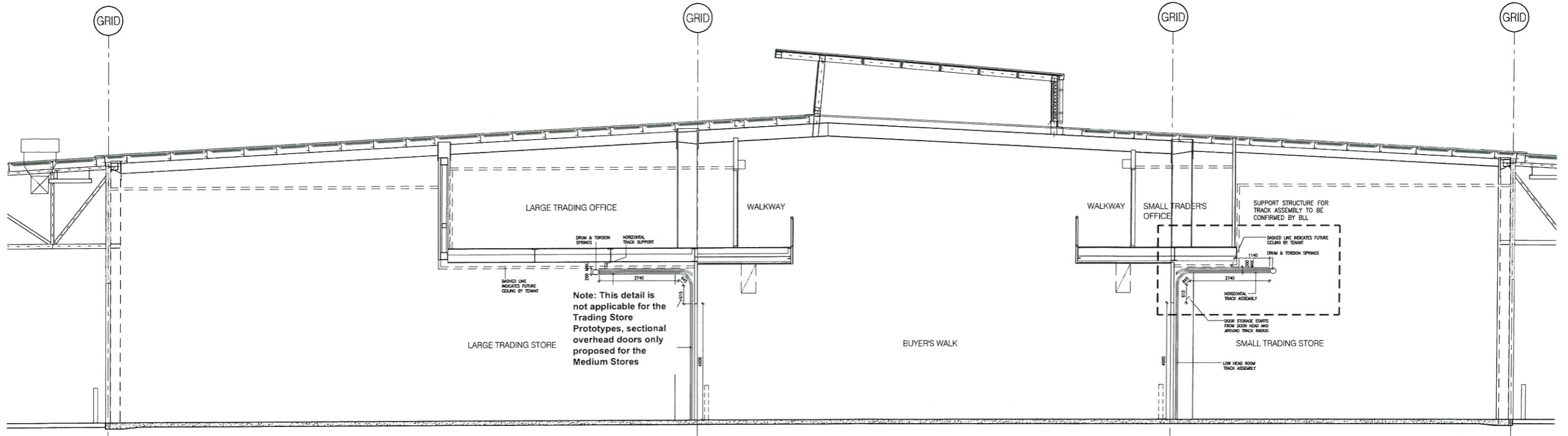

5 TYPICAL SECTION SHOWING PROPOSAL FOR SECTIONAL OVERHEAD DOOR
1:50

REV	DESCRIPTION	BY	CHK	DATE
01	ISSUED FOR INFORMATION	AG	MA	04.10.10
02	ADDITIONAL INFORMATION ADDED, ISSUED FOR INFORMATION	AG	MA	08.10.10
03	DOOR MECHANISM REVISED, ISSUED FOR INFORMATION	AG	MA	11.10.10
04	DOOR MECHANISM REVISED, ISSUED FOR INFORMATION	AG	MA	11.10.10
05	VERTICAL STEEL BE MEMBERS MOVED ON 7M OPTION	AG	MA	12.10.10
06	ISSUED FOR INFORMATION			



PROJECT: MELBOURNE MARKET RELOCATION PROJECT EPPING

CLIENT: MAJOR PROJECTS VICTORIA

ARCHITECT: Architecture Urban Design Interiors



PROJECT: MELBOURNE MARKET RELOCATION PROJECT EPPING

CLIENT: MAJOR PROJECTS VICTORIA

PROJECT: INTERNAL PIR PANELS PROPOSED OPENING TO TRADING STORES FROM BUYER'S WALK
DRAWING NO: AR-FV-4450
REVISION: D5
SCALE: 1:50
DATE: 11.10.10
DESIGNED BY: JAS
CHECKED BY: GWS

FOR INFORMATION

Attachment #1

LL mark up
6/5/13

Bulkhead (ceiling
height change)

Bulkhead (ceiling
height change)

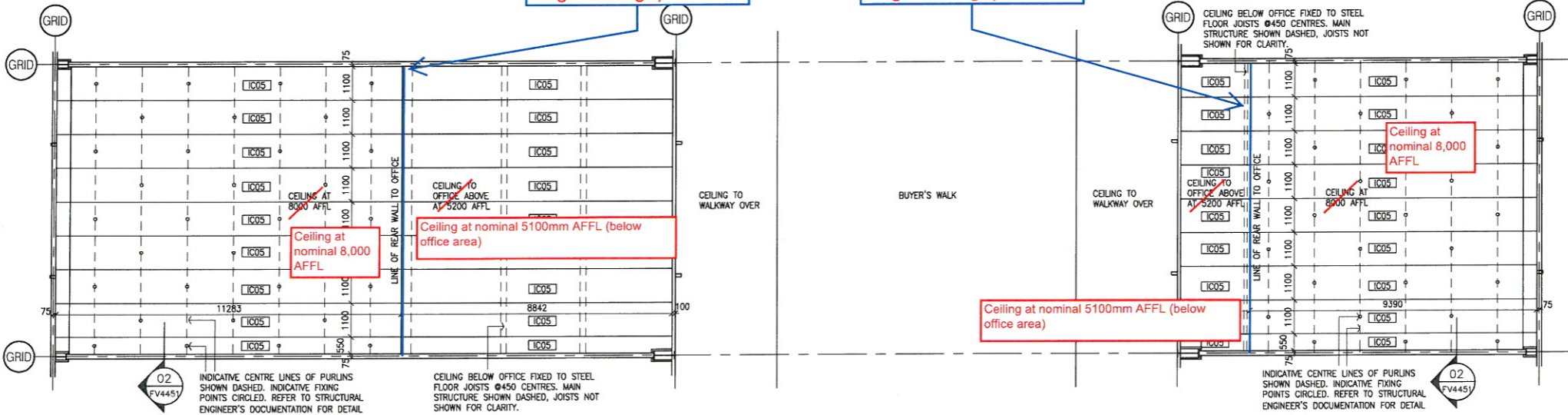

1 TYPICAL CEILING PLANS OF LARGE & SMALL TRADING STORES - 100mm THICK PANELS
- 1:100

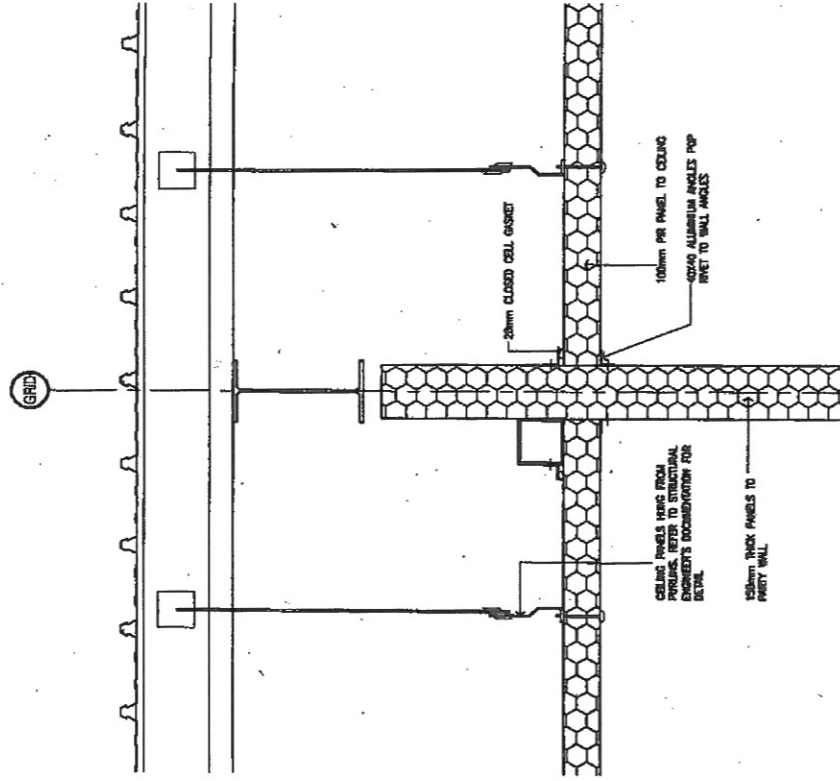

NOTE:

SERVICES PENETRATIONS ARE YET TO BE CO-ORDINATED

REFER TO FINISHES SCHEDULE FOR PIR PANEL COLOURS:

- IC01
- IC02
- IC03
- IC05

2 TYPICAL PARTY WALL / CEILING JUNCTION
1:10

SAFETY WARNING

Safe Load Limits Apply to this Ceiling

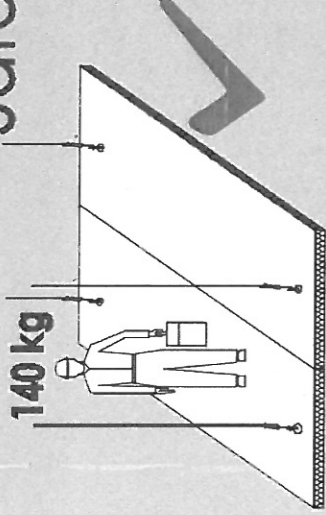

140 kg maximum is permitted on any one 1200 wide ceiling panel. e.g. One person with tools.

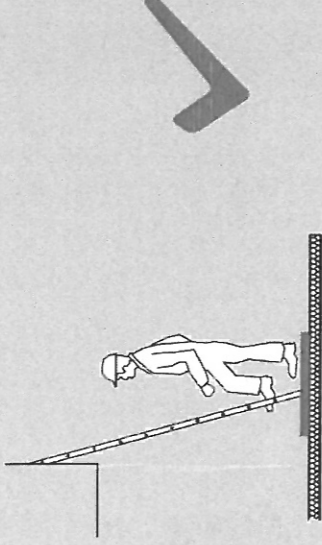

Use load spreaders under concentrated loads.
e.g. 600x600x15mm plywood under each foot of a ladder.
140 kg maximum total load per ceiling panel applies.

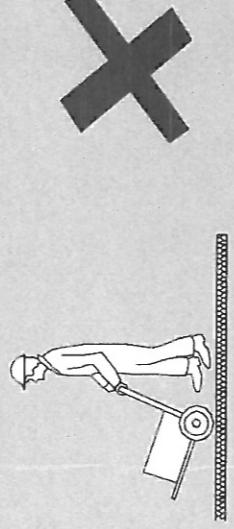

No trolley to be used.

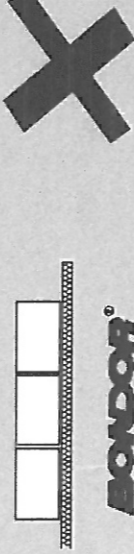

No storage of materials is permitted anytime.

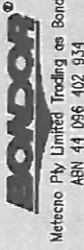

This sign is for use on ceilings designed and installed with structural adequacy. 07/04

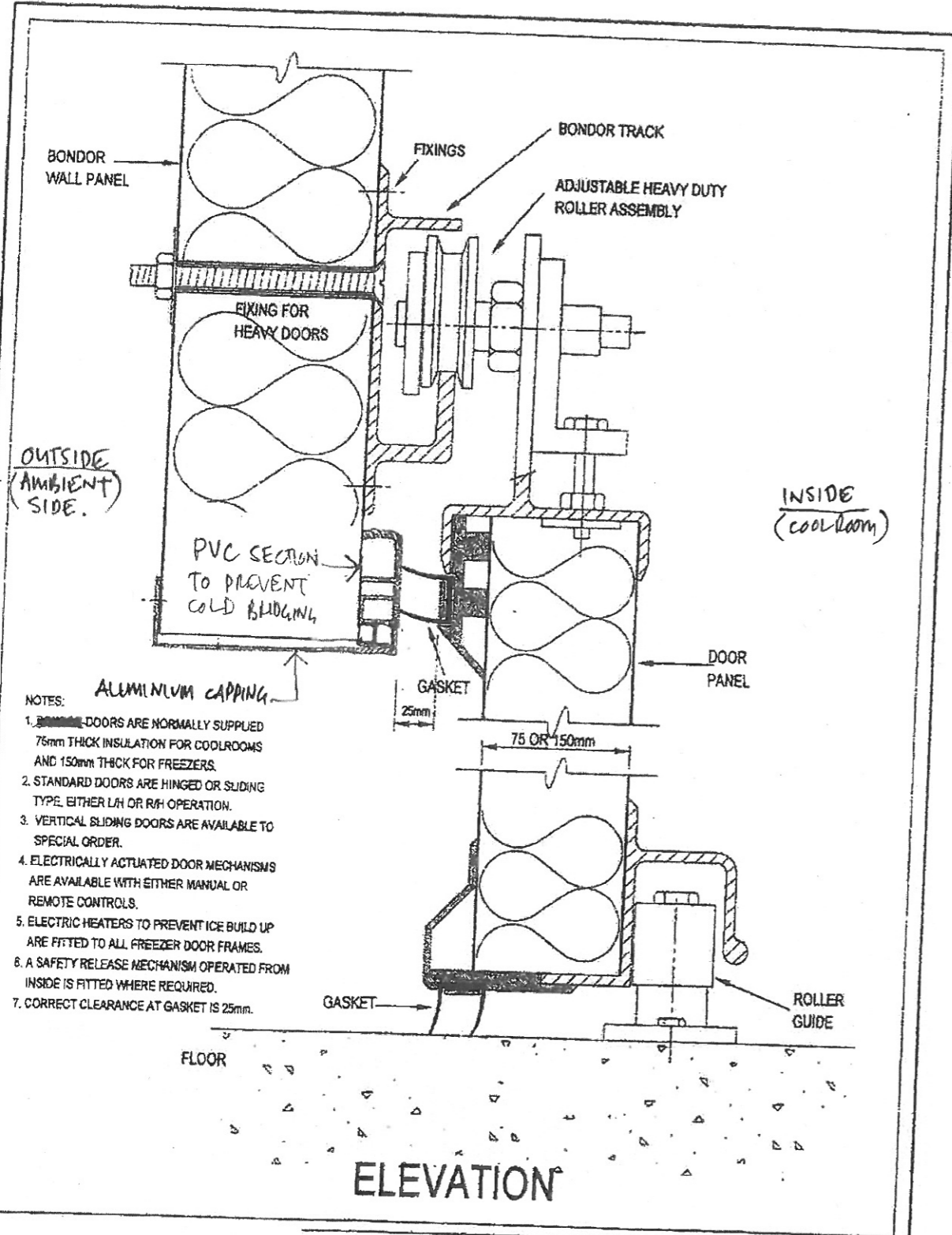

- NOTES:
1. DOORS ARE NORMALLY SUPPLIED 75mm THICK INSULATION FOR COOLROOMS AND 150mm THICK FOR FREEZERS.
 2. STANDARD DOORS ARE HINGED OR SLIDING TYPE, EITHER LH OR RH OPERATION.
 3. VERTICAL SLIDING DOORS ARE AVAILABLE TO SPECIAL ORDER.
 4. ELECTRICALLY ACTUATED DOOR MECHANISMS ARE AVAILABLE WITH EITHER MANUAL OR REMOTE CONTROLS.
 5. ELECTRIC HEATERS TO PREVENT ICE BUILD UP ARE FITTED TO ALL FREEZER DOOR FRAMES.
 6. A SAFETY RELEASE MECHANISM OPERATED FROM INSIDE IS FITTED WHERE REQUIRED.
 7. CORRECT CLEARANCE AT GASKET IS 25mm.

CLADDING WIPER SILL SLIDING DOOR

www.cladding.com.au
COLD STORAGE SYSTEMS

COLD STORAGE SYSTEM

TYPICAL TRADING STORE
SLIDING DOOR DETAIL

D01

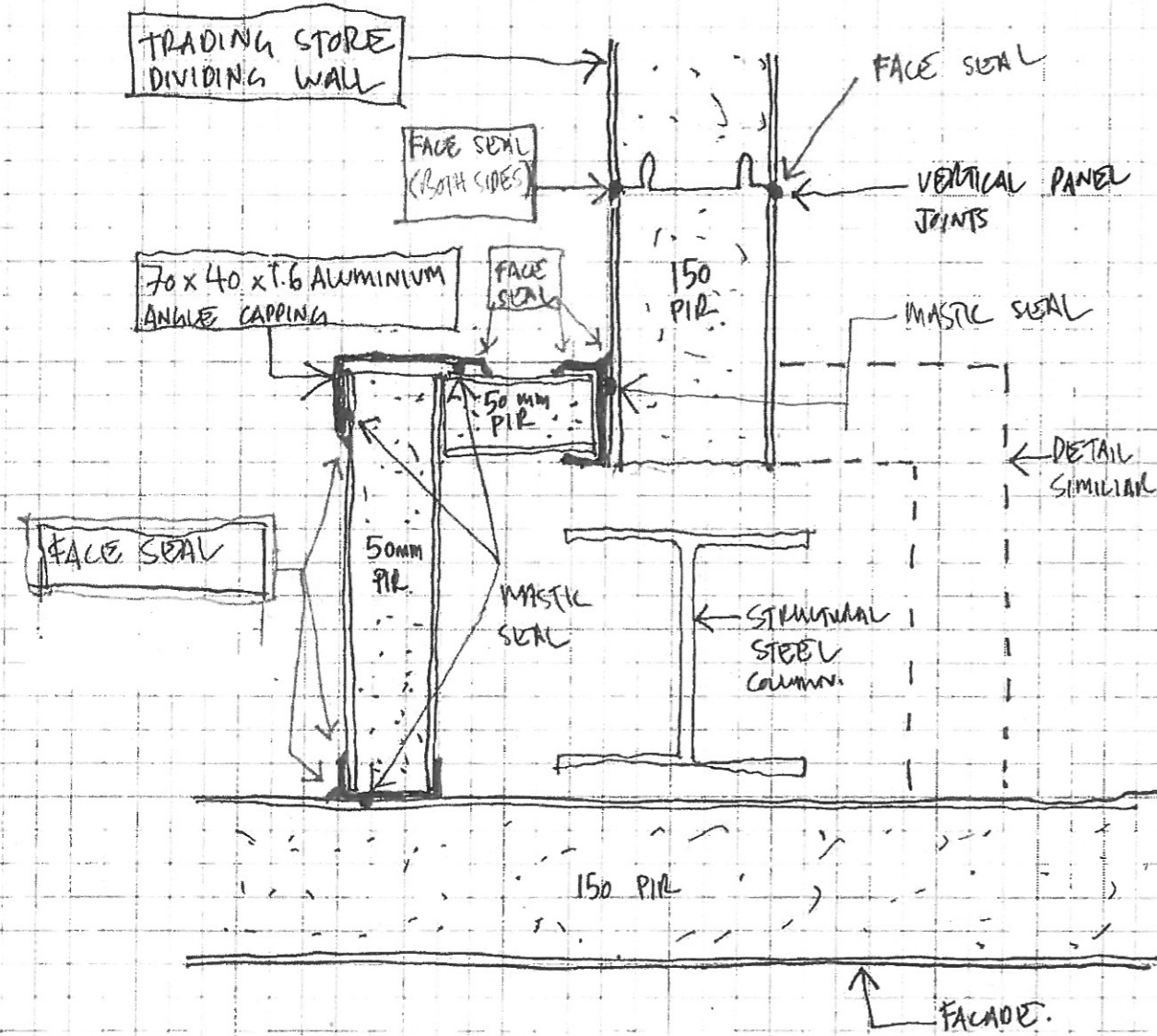

TYPICAL TRADING STORE BOXING DETAIL

DOZ REV A

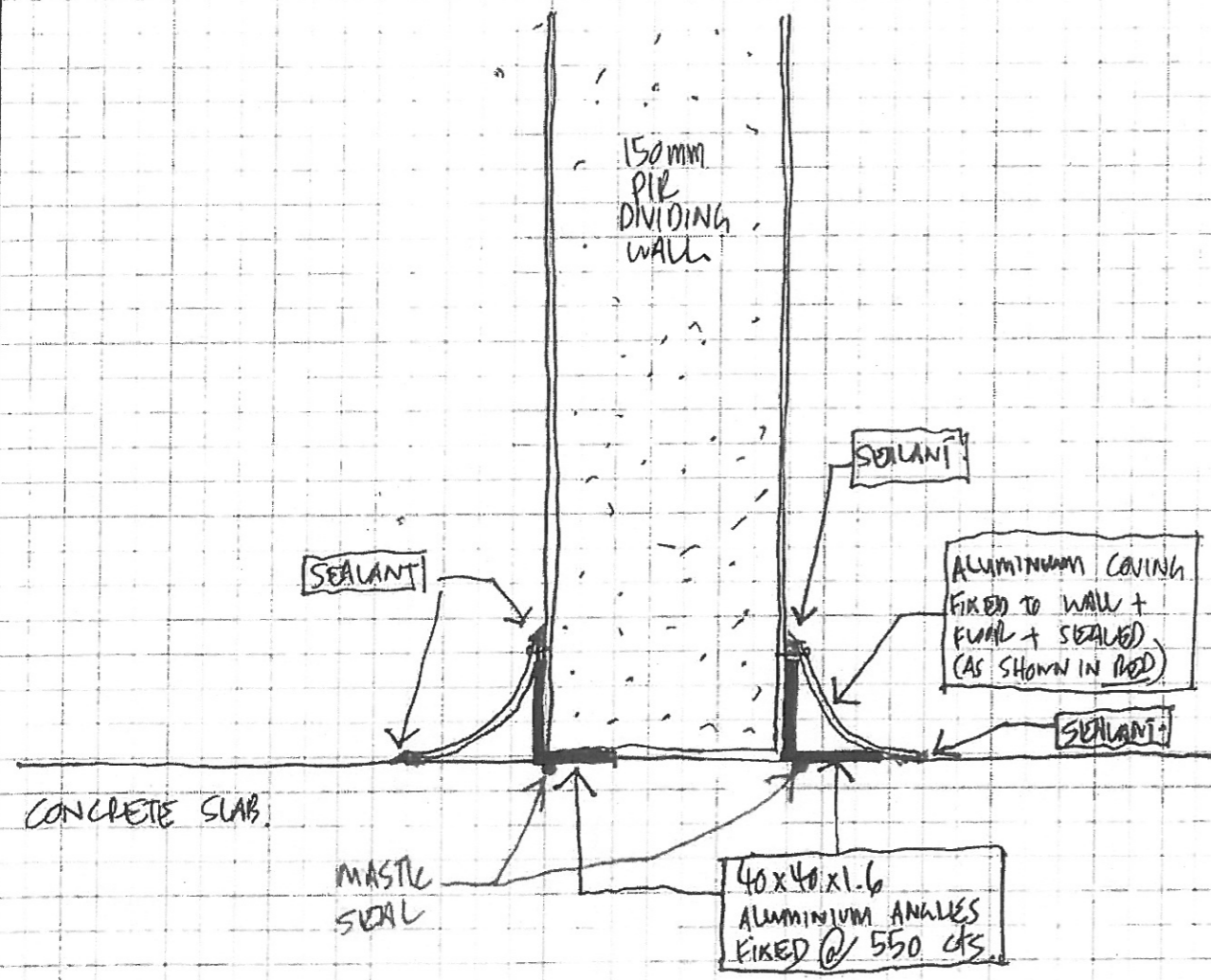

TYPICAL TRADING STORE DIVIDING WALL SECTION

[D03] MS/A

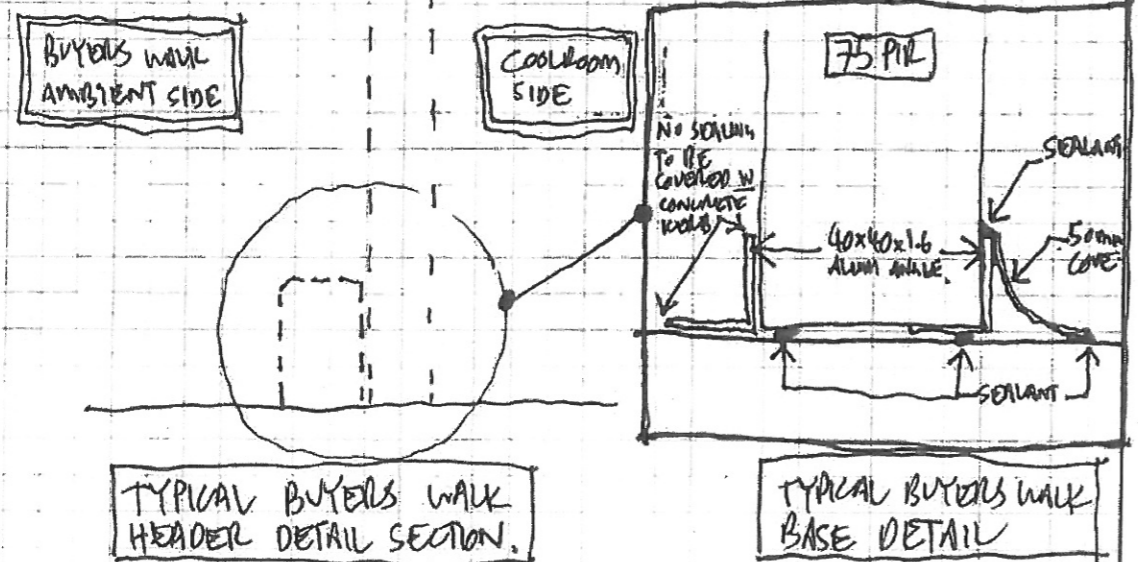
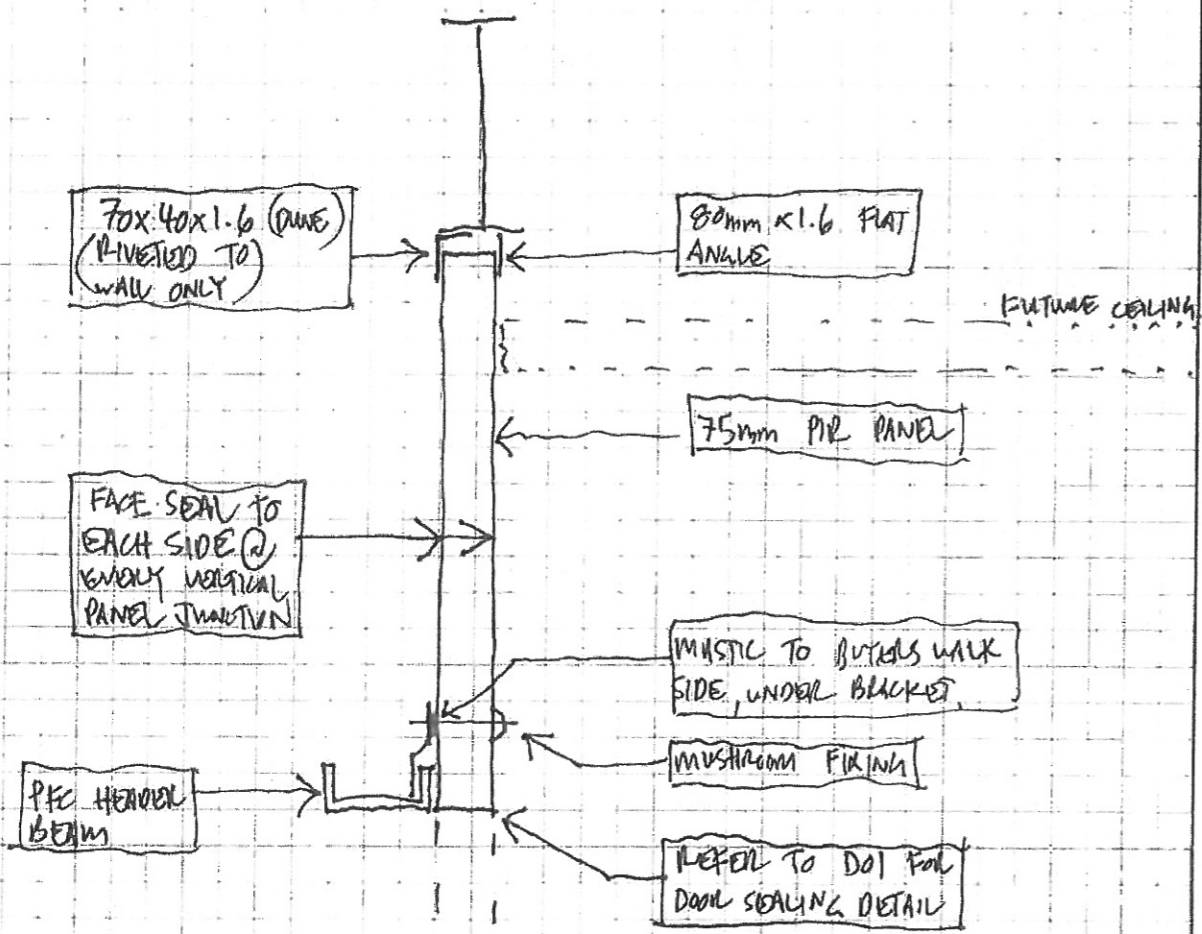

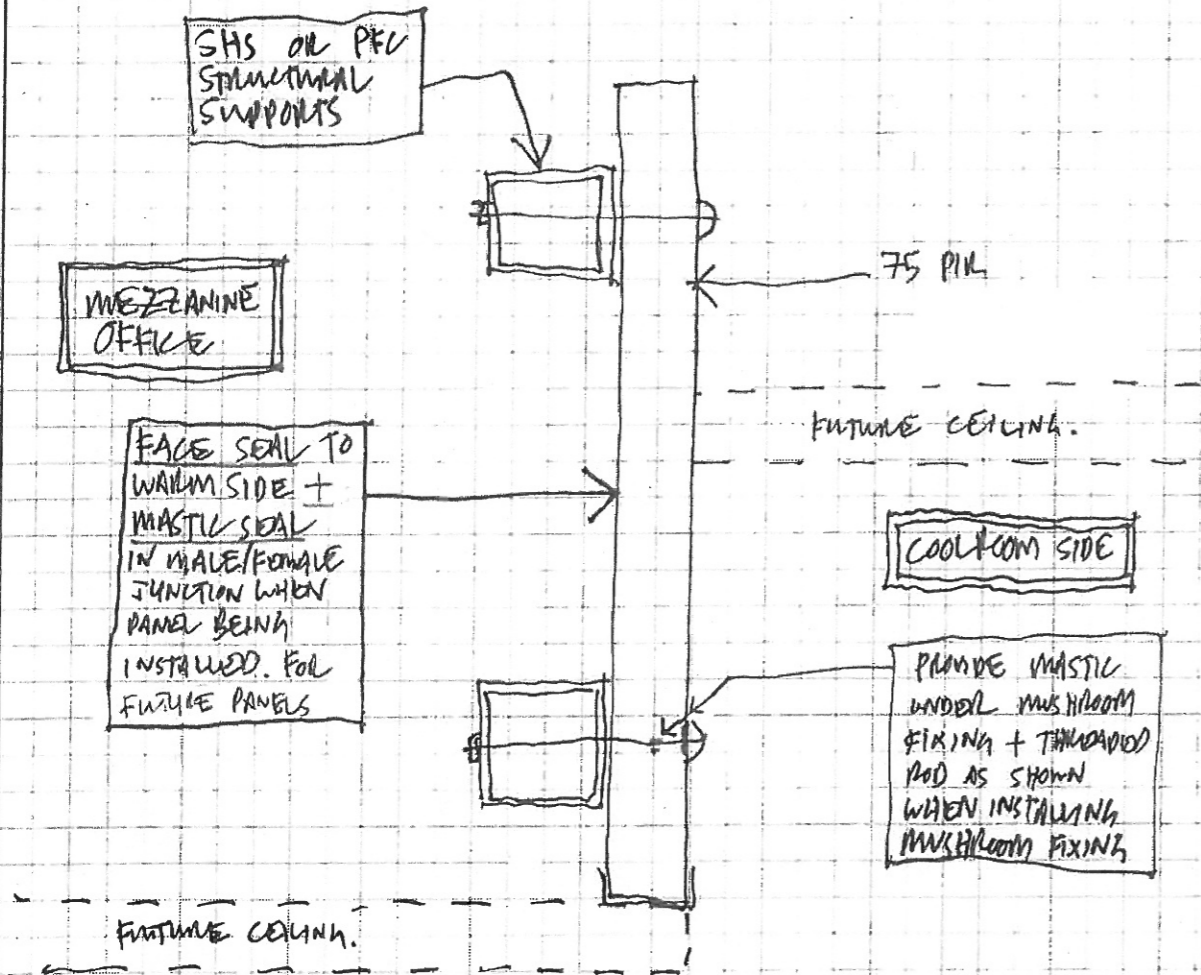

TYPICAL MEZZANINE REAR WALL SECTION

D05

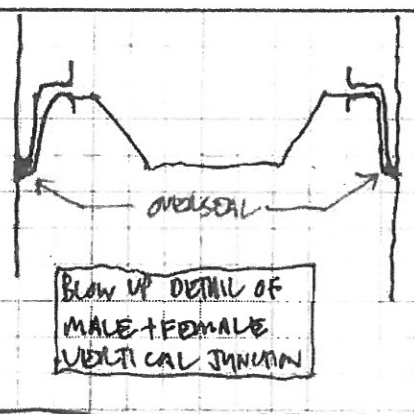

BLOW UP DETAIL OF MALE + FEMALE VERTICAL JUNCTION

SECTION A-A

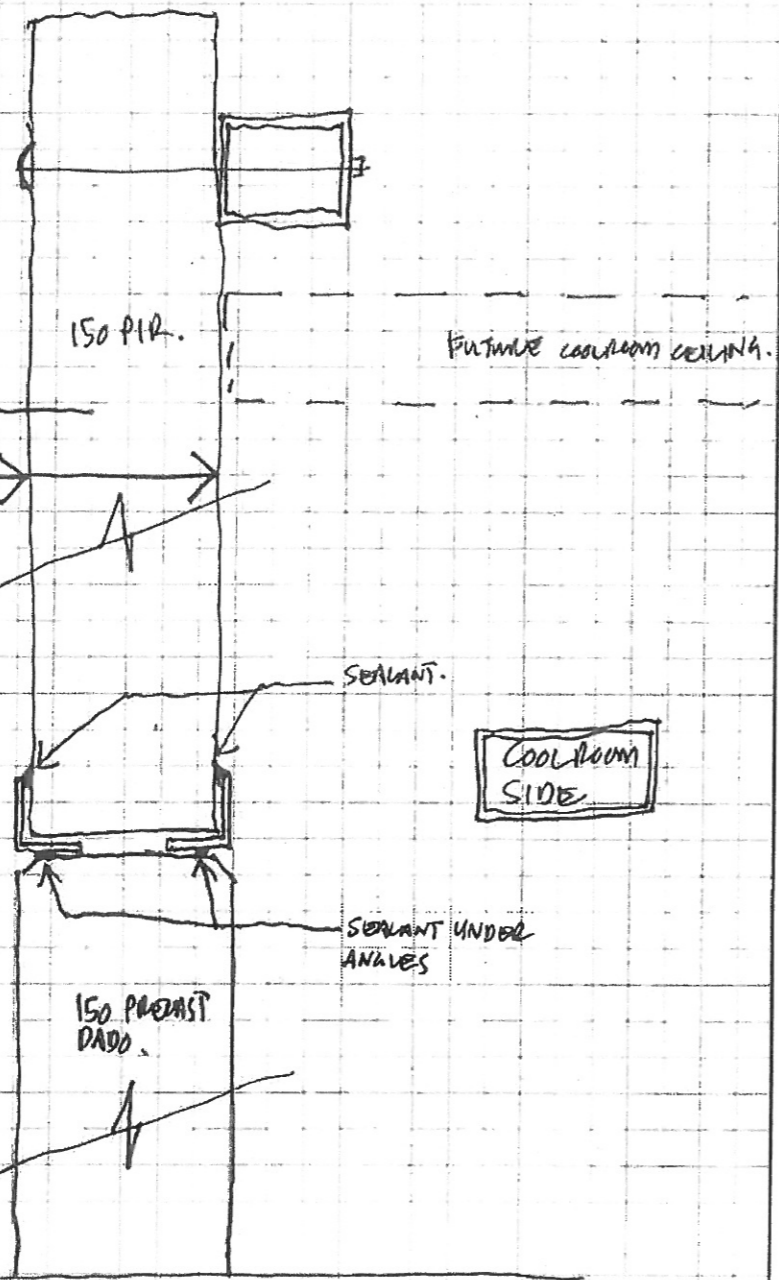

FACE SEAL TO EACH SIDE OF EACH MALE + FEMALE VERTICAL JOINT.

EXTERNAL SIDE

SEALANT.

COOLROOM SIDE

SEALANT UNDER ANGLES

150 PRECAST DADO.

TYPICAL EXTERNAL CANOPY SIDE WALL SECTION

506

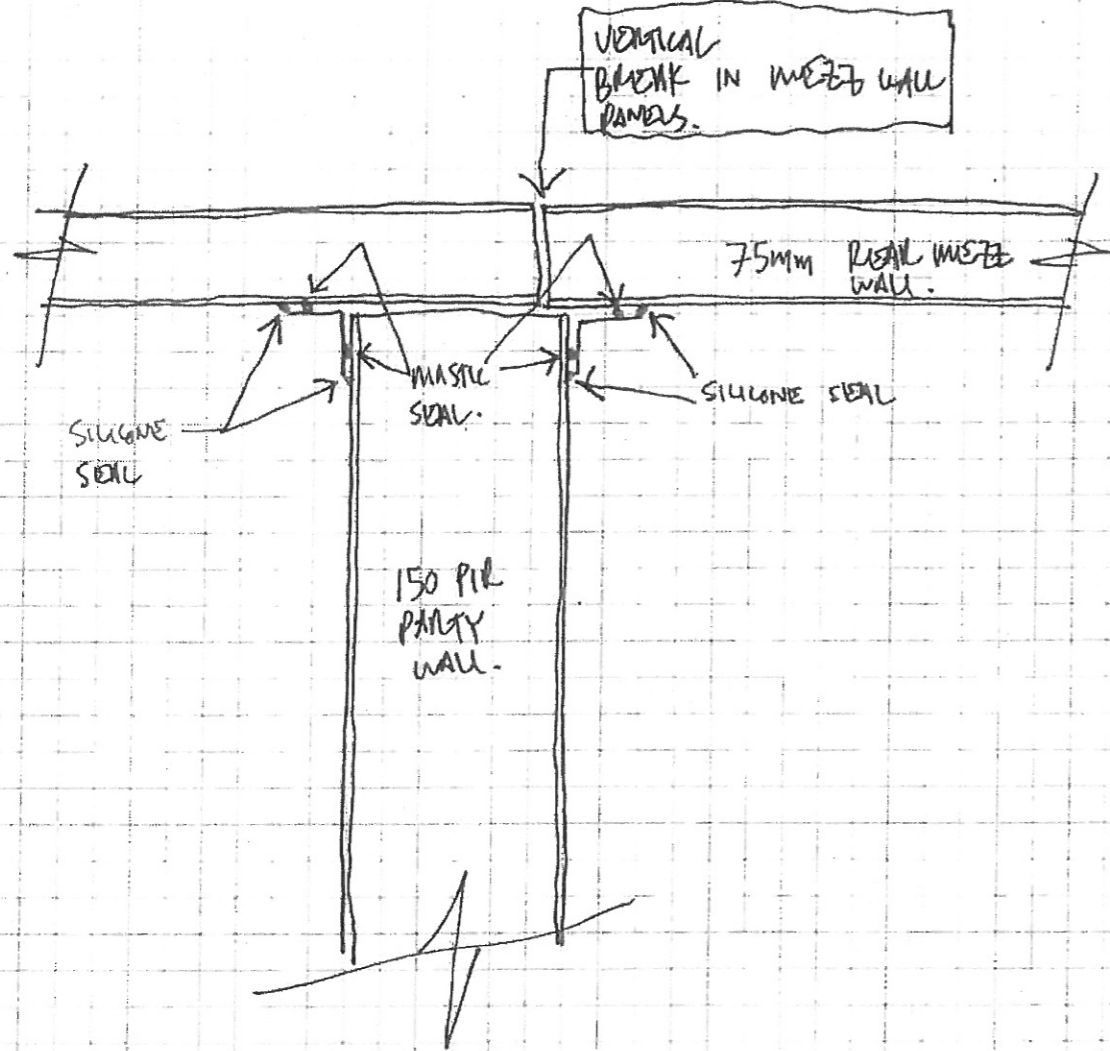

TYPICAL VERTICAL JUNCTION
B/W TENANCY PARTY WALLS
+ MASONRY OFFICE WALL

DO7

